



PRODUCT INFORMATION

The Remote Closet Cabinets, RCC Series, are designed for applications where viewing windows are not required, such as remote equipment closets. The RCC7R cabinet provides space for a single chassis, the RCC14R cabinet provides space for two chassis, and the RCC21R provides space for three chassis. All cabinets provide space for up to 50 amp-hour standby batteries. The backboxes are fabricated of 14 gauge steel and finished with a red textured enamel. The enclosures are designed for surface mounting. Conduit and nail knockouts, keyhole style mounting holes, and wide wiring troughs facilitate quick installation. Cabinet design facilitates separation of power limited and non-power limited circuits by locating power limited wiring toward the front of the cabinet and non-power limited wiring at the rear of the cabinet. The removable hinged doors mount on the left side of the backboxes and are secured with key locks.



SPECIFICATIONS

RCC7R Cabinet

Backbox and Door - Dimensions (HWD)
23.25" x 25.0" x 6.75"
(59.1 cm x 63.5 cm x 17.15 cm)

Capacity

Chassis One chassis
Battery Two 50 AH @ 12 Vdc

Door Finish

Red textured enamel

RCC14R Cabinet

Backbox and Door - Dimensions (HWD)
35.47" x 25.0" x 6.75"
(90.1 cm x 63.5 cm x 17.15 cm)

Capacity

Normal Configuration
Two chassis and and two 50 AH @ 12 Vdc

Battery Cabinet Configuration
Up to three 3-BTS battery shelves and four
65AH @ 12 Vdc batteries and two 3-BTSEN

Door Finish

Red textured enamel

RCC21R Cabinet

Backbox and Door - Dimensions (HWD)
47.72" x 25.0" x 6.75"
(121.2 cm x 63.5 cm x 17.15 cm)

Capacity

Normal Configuration
Three chassis and and two 50 AH @ 12 Vdc

Battery Cabinet Configuration
One chassis and two 3-BTS battery shelves
with one 65AH @ 12 Vdc battery per shelf

Door Finish

Red textured enamel



CABINET INSTALLATION

1. Mount the backbox at the required location. Cabinet installation dimensions are on the back page. A dedicated 120 VAC (for systems using model 3-PPS/M power supplies), or 230 VAC (for system using model 3-PPS/M-230 power supplies) 50/60 Hz circuit is required for each cabinet. Install all conduit and pull all wiring into the backbox before proceeding to the next step.
2. Install the equipment chassis. Refer to chassis installation sheet for details.
3. Connect the door ground strap between the stud on the door and the backbox using the hardware provided.

PRODUCT DIAGRAM

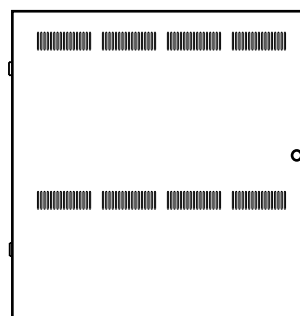

RCC7R

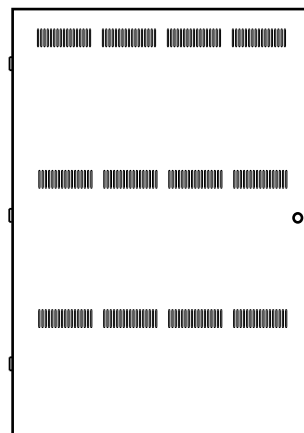

RCC14R

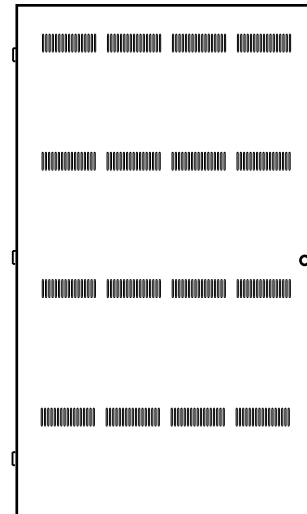

RCC21R

INSTALLATION SHEET

3-RCC Series Remote Closet Cabinets

INSTALLATION SHEET P/N: 270486

FILE NAME: 270486.CDR

REVISION LEVEL: 4.0

DATE: 15AUG06



CABINET INSTALLATION DIMENSIONS

CAUTION: When used as a battery cabinet, fasten the cabinet securely to the wall studs or framing. A loaded cabinet weighs in excess of 200 lbs. (90 kg).

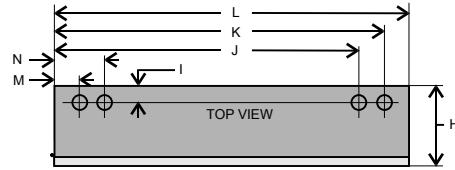

ALL KNOCKOUTS FOR 3/4" CONDUIT (1.9 cm)

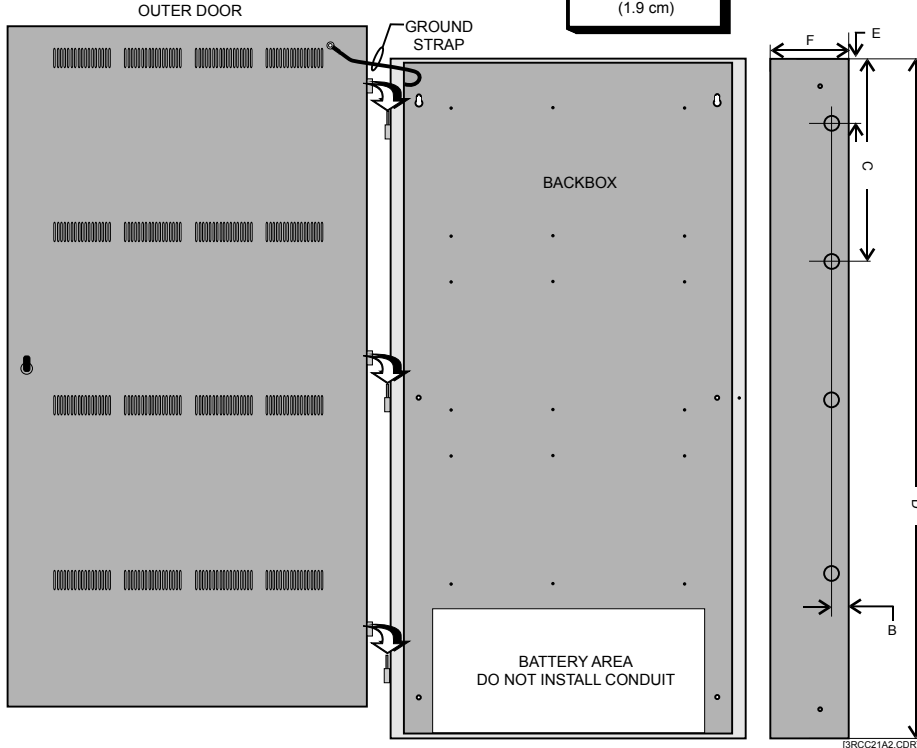

	RCC7R	RCC14R	RCC21R
A	23.36 in (59.3 cm)	35.61 in (90.4 cm)	47.75 in (121.29 cm)
B	1.25 in (3.18 cm)	1.25 in (3.18 cm)	1.25 in (3.18 cm)
C	14.1 in (35.8 cm)	14.1 in (35.8 cm)	14.1 in (35.8 cm)
D	23.25 in (59.1 cm)	35.47 in (90.1 cm)	47.72 in (121.21 cm)
E	4.37 in (11.1 cm)	4.37 in (11.1 cm)	4.37 in (11.1 cm)
F	5.5 in (13.97 cm)	5.5 in (13.97 cm)	5.5 in (13.97 cm)
G	1.25 in (3.18 cm)	1.25 in (3.18 cm)	1.25 in (3.18 cm)
H	5.5 in (13.97 cm)	5.5 in (13.97 cm)	5.5 in (13.97 cm)
I	1.25 in (3.18 cm)	1.25 in (3.18 cm)	1.25 in (3.18 cm)
J	21.44 in (54.46 cm)	21.44 in (54.46 cm)	21.44 in (54.46 cm)
K	23.25 in (59.03 cm)	23.25 in (59.03 cm)	23.25 in (59.03 cm)
L	25.0 in (63.5 cm)	25.0 in (63.5 cm)	25.0 in (63.5 cm)
M	1.75 in (4.45 cm)	1.75 in (4.45 cm)	1.75 in (4.45 cm)
N	3.55 in (9.01 cm)	3.55 in (9.01 cm)	3.55 in (9.01 cm)

POWER LIMITED AND NON-POWER LIMITED WIRING REQUIREMENTS

Fire Alarm System wiring is classified as either Power Limited or Non-Power Limited per NEC Article 760. All power limited wiring must be separated from all non-power limited wiring by a minimum distance of 1/4 in (6 mm). The system enclosures and chassis assemblies are designed such that non-power limited wiring is at the left rear of the cabinet and the power limited wiring is at the front of the cabinet. When installing non-power limited wiring, use the feed through notches at the left rear of the chassis. When installing power limited wiring, use the feed through notches at the right front of the chassis.

